

Canal Towpath Improvements

Background

The West Yorkshire Combined Authority's CityConnect programme is delivering improvements to cycling and walking infrastructure and routes across the region.

Working in partnership with councils across West Yorkshire and York, we are aiming to improve and encourage more people to make more every-day journeys by bike or on foot.

To deliver a wide range of transport improvements the West Yorkshire Combined Authority's CityConnect programme is seeking £12 million funding through the West Yorkshire-plus Transport Fund, and the Leeds City Region Growth Deal - a £1 billion package of Government investment through the Leeds City Region Enterprise Partnership (LEP), delivered by the West Yorkshire Combined Authority to accelerate growth and create jobs across Leeds City Region.

Improvements to the canal towpath network

The West Yorkshire Combined Authority have been working in partnership with Canal & River Trust, as well as our partner councils, to invest in and improve the canal towpath network across West Yorkshire, to enable more journeys on foot and by bike.

The next phase of this programme of improvements will aim to improve areas of the towpath network along both the Huddersfield Narrow Canal and the Leeds & Liverpool Canal. The areas identified for improvements are outlined below, and we are seeking your views on the proposals, to allow these plans to be taken to the next stage.

Leeds & Liverpool Canal Towpath Improvements

Shipley to Apperley Bridge

Silsden to the West Yorkshire border

The proposed improvements in Bradford will focus on the Leeds & Liverpool Canal and on two distinct areas; between Shipley to Apperley Bridge and from Silsden towards Kildwick, but ending at the West Yorkshire border.

These proposals include:

- Improving the towpath surface to
 - help people to walk and cycle
 - help people with mobility difficulties or people who use mobility aids to access for the route
- Widening the towpath, where possible, whilst also keeping grass verges and native plants and trees, to support wildlife
- Putting in new signs and removing any unnecessary access barriers

Overview Map (Shipley to Apperley Bridge)

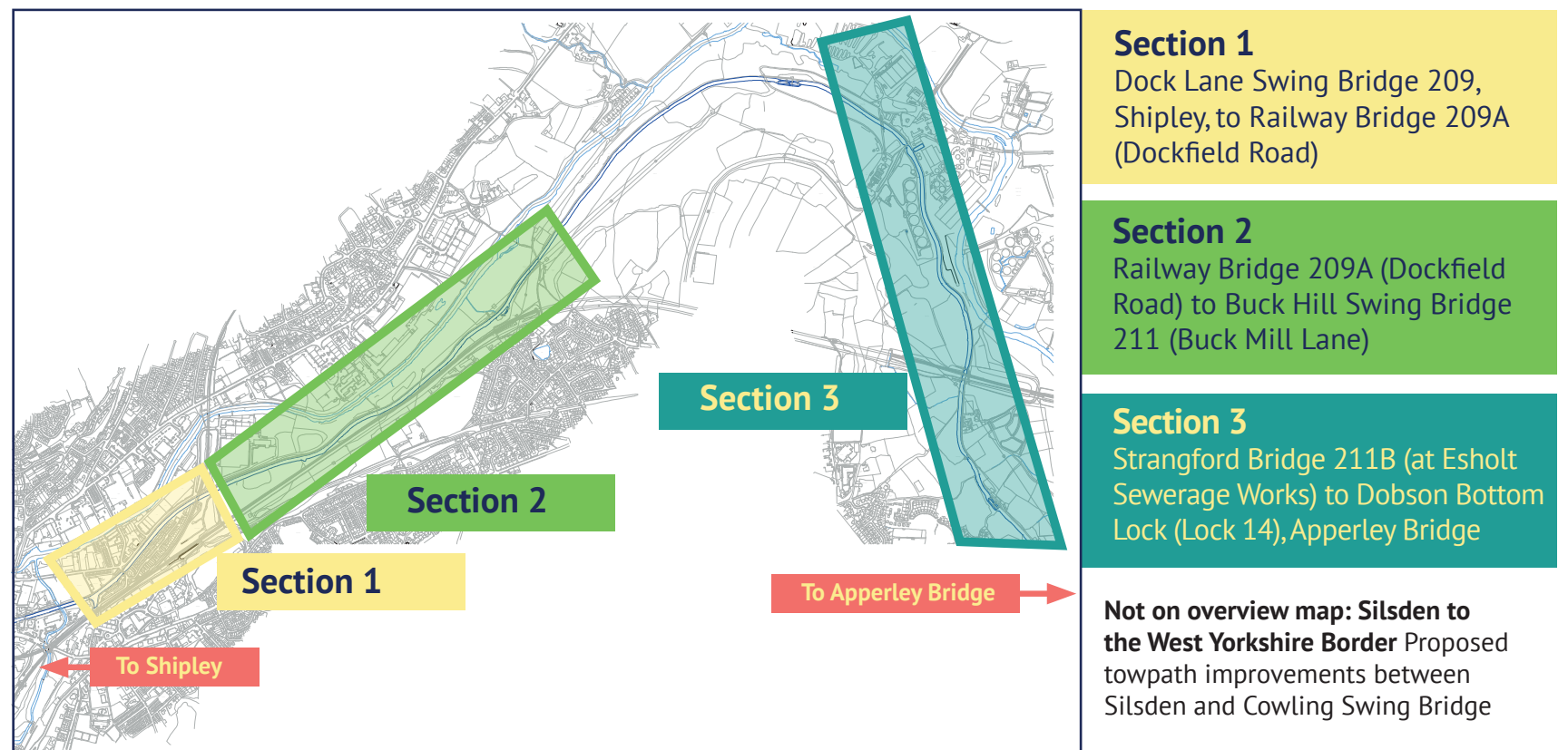

Leeds & Liverpool Canal, Shipley to Apperley Bridge, Section 2
Railway Bridge 209A (Dockfield Road) to Buck Hill Swing Bridge 211 (Buck Mill Lane)

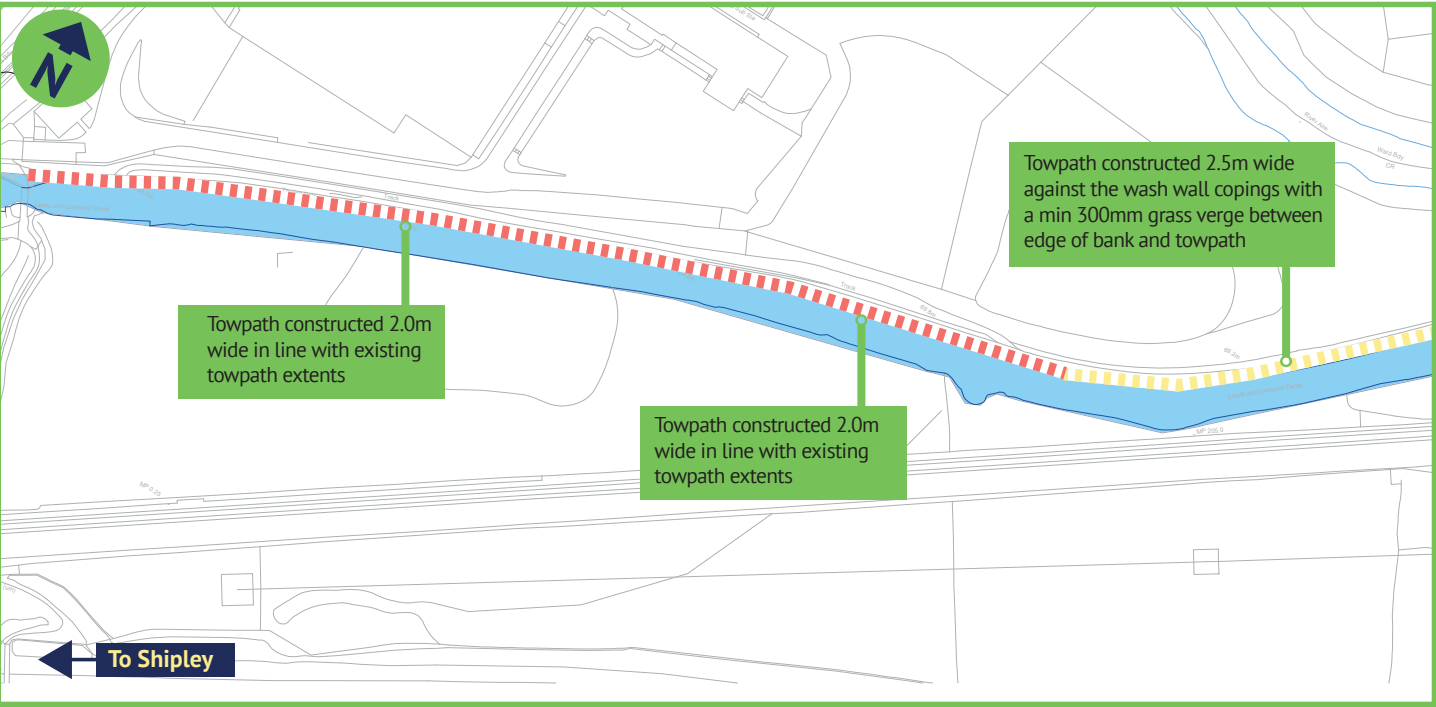

Key

- Towpath width 1.2 - 2.0m
- Partial towpath construction
 - Full towpath construction
- Towpath width 2.0 - 2.5m
- Partial towpath construction
 - Full towpath construction
- Cobbled area to be re-laid like for like

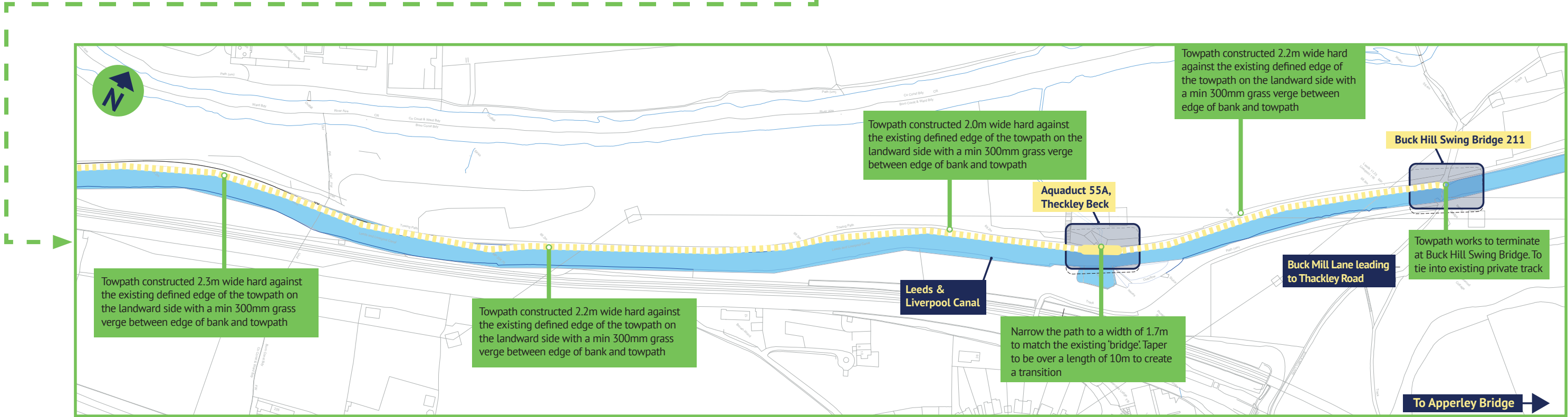

Leeds & Liverpool Canal, Shipley to Apperley Bridge, Section 3
Strangford Bridge 211B (at Esholt Sewerage Works) to Dobson Bottom Lock (Lock 14), near Apperley Bridge

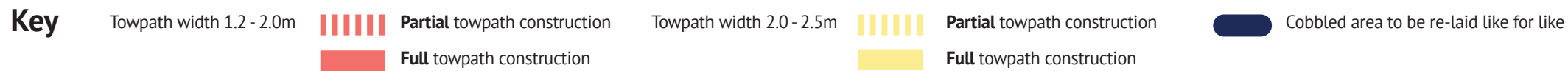
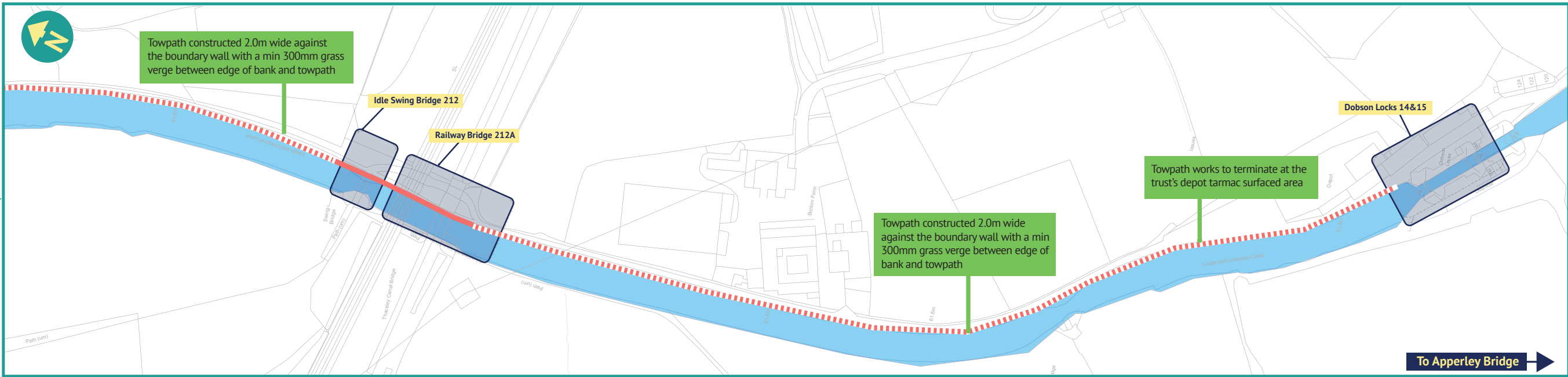
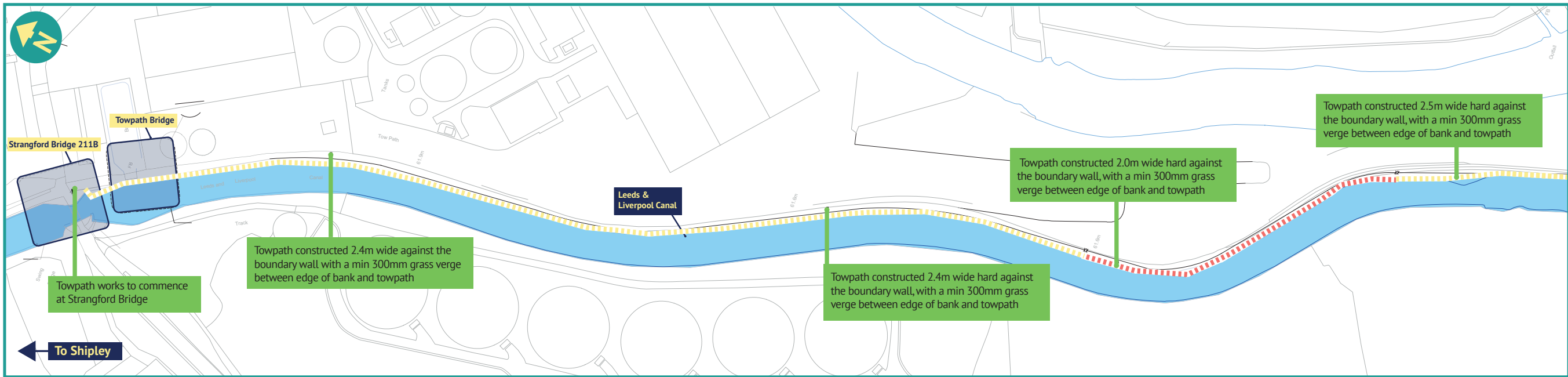

Leeds & Liverpool Canal, Silsden to the West Yorkshire Border
Proposed towpath improvements between Silsden and Cowling Swing Bridge



Towpath between Riddlesden and Silsden town centre improved in August 2018.

Key  Towpath to be constructed between 1.5 - 2.0m wide